



LED BAR

AREAS OF APPLICATION

Shops • Cafes • Restaurants • Offices • Training Halls • Hospitals
Suitable for use in the areas requiring decorative and high lumen lighting.



LED BAR LED BATTEN LIGHT

LED BATTEN LIGHT



PRODUCT SPECIFICATIONS

- Body** : PC Body / PC Cover
- Optic Cover** : Opal PC Difuser
- Led Chip** : Osram-Samsung-Seoul
- Input Voltage** : 220-240V/AC 50-60Hz
- Temperature Range** : -20°C~+40°C
- CRI** : CRI > 80
- IP Class** : IP40
- Options** : Color Temperature: 3200K/4000K/6500K
Red/Green/Blue/Amber/Meat
Including magnet that sticks on metal perfectly.
Optional Magnetic Led Bar Light



Including magnet that sticks on metal perfectly.
Optional Magnetic Led Bar Light

**OPTIONAL
MAGNETIC
LED BAR**

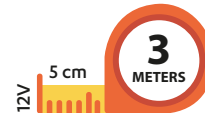

It manufactures in 5 cm modular and extendable up to 3 mt.

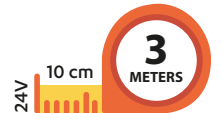

It manufactures in 10 cm modular and extendable up to 3 mt.

PHOTOMETRIC DISTRIBUTION

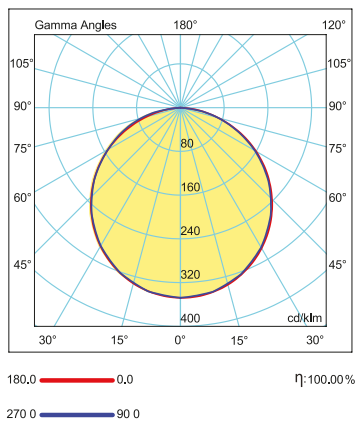

TECHNICAL DRAWING

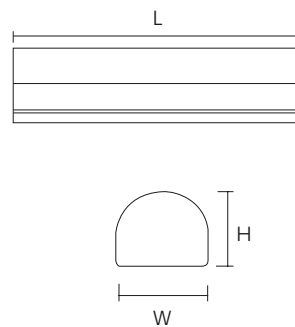

FIXTURE ACCESSORIES



PRODUCT SPECIFICATIONS

Item Code	Power (W)	Luminaire Lumen (lm)	Color Temperature (K)	Efficiency (lm/W)	Dimensions (LxWxH)	Qty/Carton	Carton Size (LxWxH)	G.W/Carton
LLN12.014	14W	1.050	3000/4000/6500	75lm/W	1000x22x18mm	-	-	-

*3N Company has the right to make any changes it deems necessary without prior notice.
*Technical data has a tolerance of ±10%.